



**MARK V 200  
ELECTRIC CONVECTION OVEN  
REPLACEMENT PARTS LIST**

**EFFECTIVE AUGUST 10, 2021**

Superseding All Previous Parts Lists.

The Company reserves the right to make substitution in the event that items specified are not available.

ERRORS: Descriptive and/or typographic errors are subject to correction.

---

**BLODGETT OVEN COMPANY**

42 Allen Martin Drive, Essex Junction, Vermont 05452 USA Telephone: (802) 658-6600 Fax: (802) 860-3732  
[www.blodgett.com](http://www.blodgett.com)

*P/N 59559 Rev G*

## SERIAL NUMBER LOCATION / KEY:

***IMPORTANT: When ordering parts, please provide the model, voltage and serial number of the oven. The identification plate is located on the right side of the oven and behind the control panel.***

- ☑ ASAP Distributor Required Stocking Parts
- ◆ Doors Are Not Returnable
- \* Item Is Too Large For UPS

**SERIAL NUMBER IDENTIFICATION CODE:  
CW = MARK V 200**

### **SERIAL NUMBER EXAMPLES**

**121616CW001T  
12/16/16 = DATE  
CW = LETTER CODE FOR MARK V 200  
001 = FACTORY SEQUENCE  
T = TOP OVEN**

#### **TO OBTAIN LITERATURE:**

Email: [literature@blodgett.com](mailto:literature@blodgett.com)  
or visit  
[www.blodgett.com](http://www.blodgett.com)

# TABLE OF CONTENTS

|   |    |
|---|----|
| INTERIOR COMPONENTS.....                                | 4  |
| DOOR COMPONENTS .....                                   | 4  |
| SOLID STATE INFINITE CONTROL WITH DIGITAL TIMER .....   | 5  |
| SOLID STATE INFINITE CONTROL WITH 60 MINUTE TIMER ..... | 6  |
| SOLID STATE DIGITAL CONTROL.....                        | 7  |
| SIMPLE TOUCH CONTROL .....                              | 8  |
| ELECTRICAL COMPONENTS .....                             | 10 |
| EXTERIOR COMPONENTS .....                               | 11 |
| ROLL-IN UNIT AND PARTS.....                             | 11 |

# INTERIOR COMPONENTS

| <b>Ref. No.</b> | <b>Part No.</b> | <b>Description</b>               |
|-----------------|-----------------|----------------------------------|
| 1               | 5001            | Blower Wheel Assy.               |
|                 | 16813           | Liner Baffle, Porcelain          |
|                 | 16814           | Liner Baffle, s/s                |
|                 | 20246           | Rack, Oven (27-7/8" x 28-3/16")  |
|                 | 21422           | Rack Support (Set of 2)          |
|                 | 90046           | Support Assy., Baffle (Set of 4) |
|                 | 19667           | Motor Mount & Panel Assy.        |
| 2               | 33088           | Clip, Thermostat Bulb RTD        |
|                 | 19639           | Baffle Screen                    |

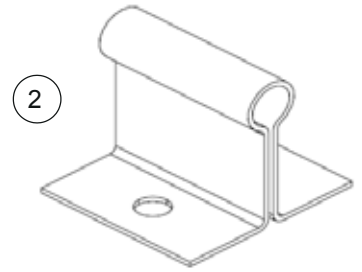
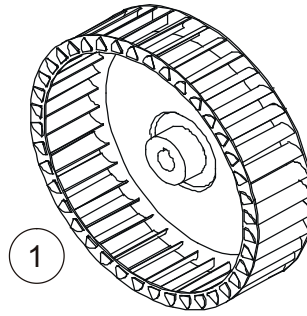

# DOOR COMPONENTS

| <b>Ref. No.</b> | <b>Part No.</b> | <b>Description</b>                        |
|-----------------|-----------------|---|
| ◆               | 20806           | Door Assy., Solid LH                      |
| ◆               | 20805           | Door Assy., Solid RH                      |
| ◆               | 20804           | Door Assy., Glass LH                      |
| ◆               | 20803           | Door Assy., Glass RH                      |
| 1               | 35702           | Microswitch                               |
| 2               | 90004           | Bushings, Door Hinge (Set of 2)           |
| 3               | 16657           | Sleeve, Upper Door Bushing                |
| 4               | 17557           | Hinge Pin, Upper Door                     |
|                 | 9036            | Window Assy., Drop In (10-1/8" x 17-1/8") |
|                 | 17558           | Handle, Porcelain Door                    |
|                 | 18081           | Top Plate, Door Handle                    |
|                 | 17311           | Trim, Center Door                         |
|                 | 36606           | Pressure Lock                             |
|                 | 36876           | Door Gasket, Perimeter                    |
|                 | 36037           | Support Assy., Lower Door                 |
|                 | 4887            | Chain & Turnbuckles, Door Operating       |

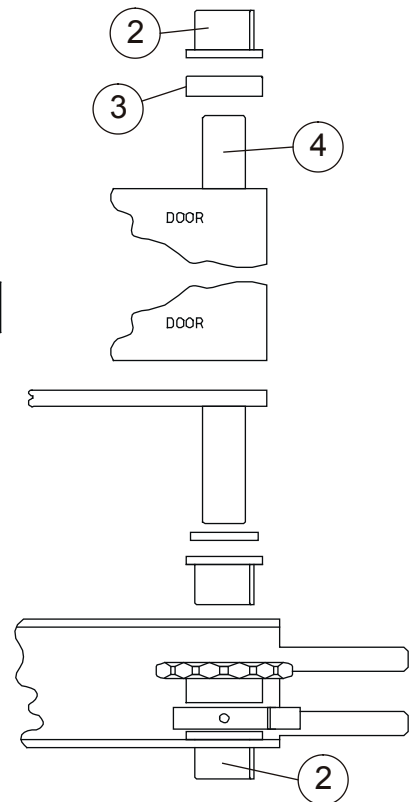
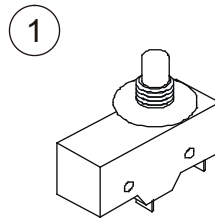

# SOLID STATE INFINITE CONTROL WITH DIGITAL TIMER

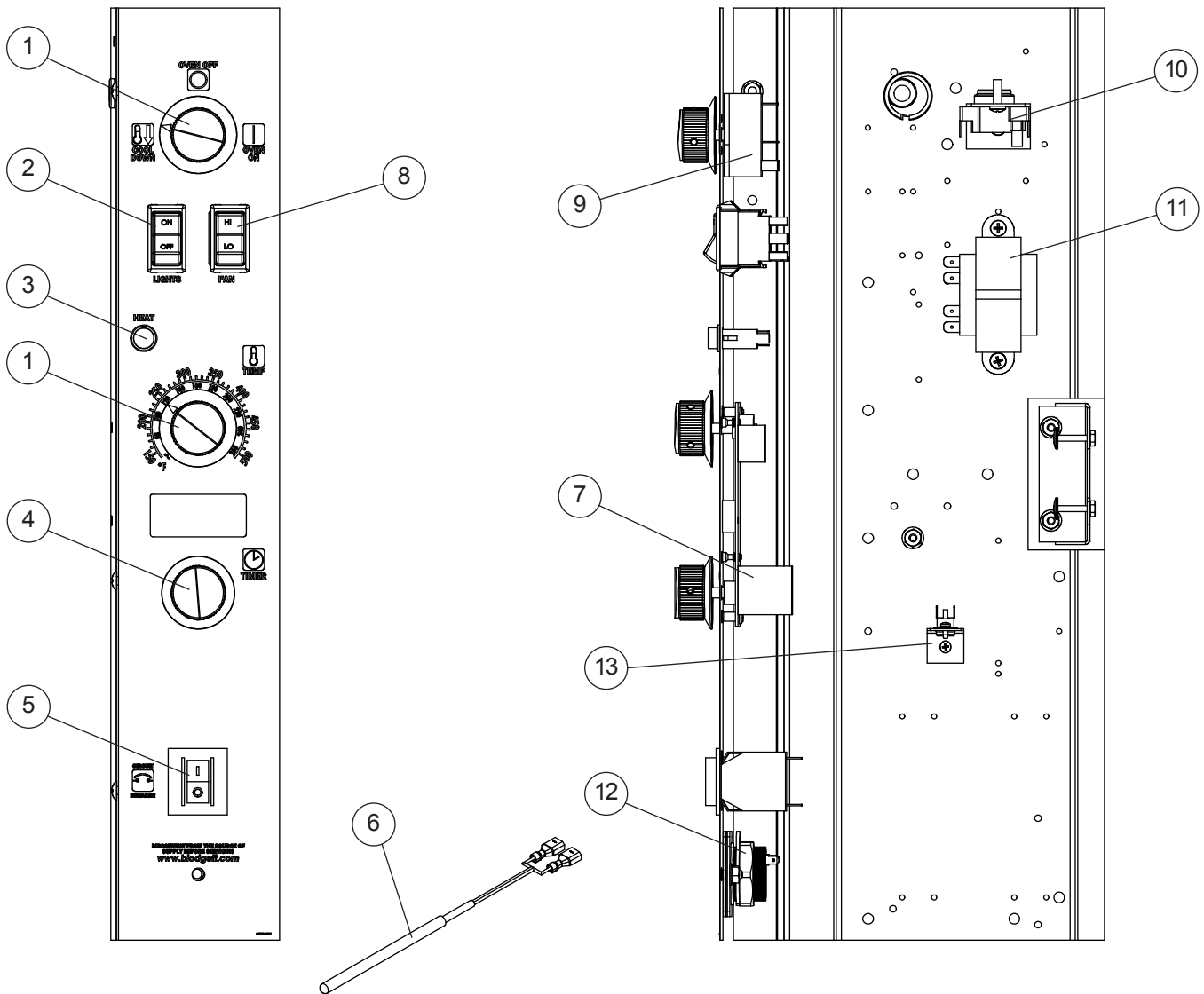

| Ref. No. | Part No. | Description                             |
|----------|----------|---|
| 1        | 36616    | Knob w/Arrow                            |
| 2        | 6497     | Light Switch, SPST, White               |
| 3        | 18265    | Indicator Light, 28V                    |
| 4        | 36617    | Knob, w/o Arrow                         |
| 5        | 36429    | Circuit Breaker                         |
| 6        | 57562    | Probe, 1K Ohm, 3/16" terminals          |
|          | 57563    | Module Assy. w/probe                    |
|          | 57566    | Panel & Decal, infinite w/digital timer |

| Ref. No. | Part No. | Description                         |
|----------|----------|-------------------------------------|
| 7        | 57561    | Temperature Control w/Digital Timer |
| 8        | 20530    | Blower Switch, 3PDT, Black          |
| 9        | 18868    | Mode Switch w/o Knob, 3 Positions   |
| 10       | 36755    | Thermal Switch                      |
| 11       | 36700    | Transformer, 120/240 to 24V         |
| 12       | 52668    | Beeper                              |
| 13       | 56760    | Thermal Switch, Manual Reset        |

# SOLID STATE INFINITE CONTROL WITH 60 MINUTE TIMER

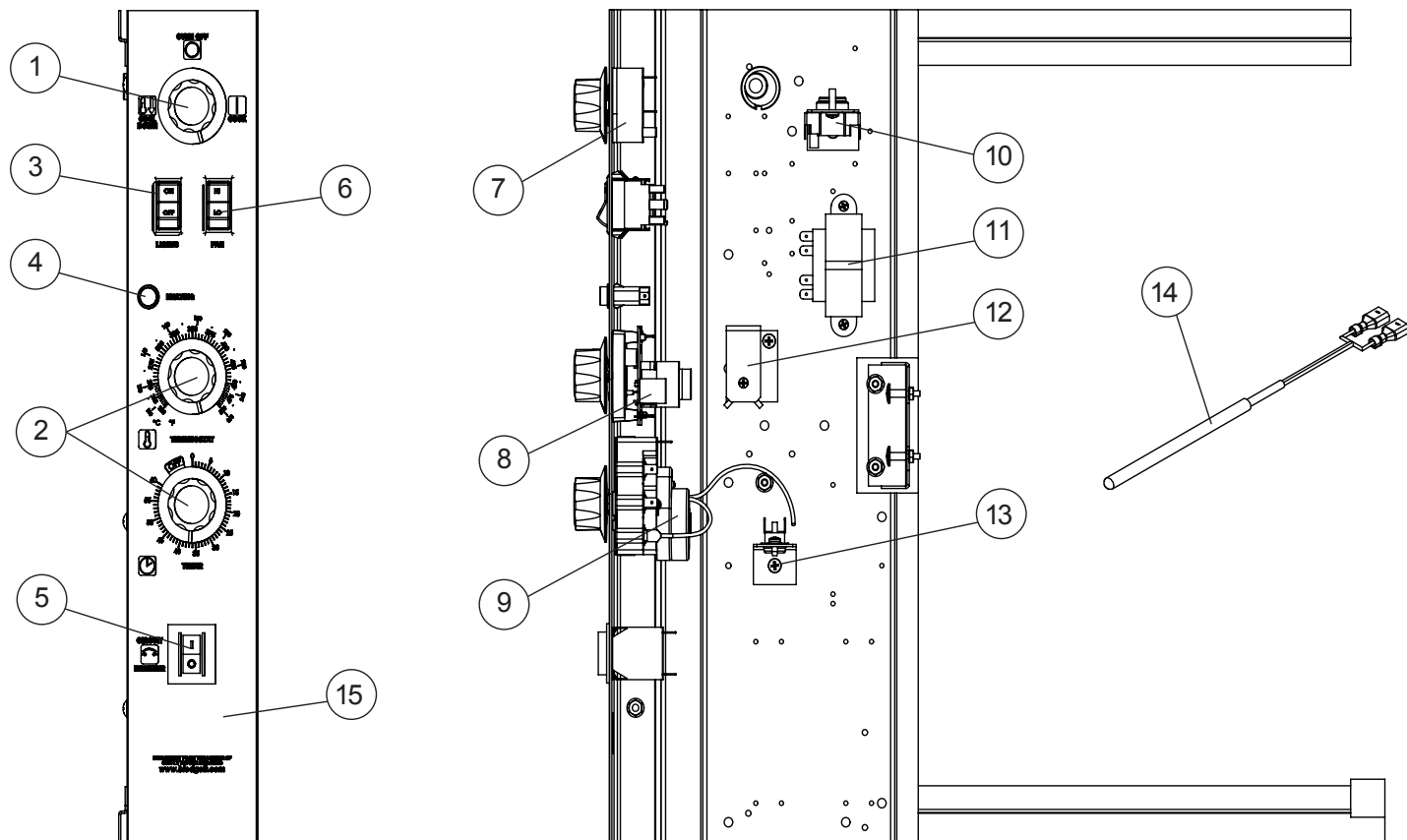

| Ref. No. | Part No. | Description                     |
|----------|----------|---------------------------------|
| 1        | 16686    | Knob, Mode Switch               |
| 2        | 16686    | Knob, Thermostat/Timer          |
| 3        | 6497     | Light Switch, Rocker SPST White |
| 4        | 18265    | Light, Indicator 28V Red        |
| 5        | 36429    | Circuit Breaker                 |
| 6        | 20530    | Blower Switch, Rocker 3PDT      |
| 7        | 18868    | Mode Switch                     |
| 8        | 57372    | Thermostat, RTD                 |

| Ref. No. | Part No. | Description                        |
|----------|----------|------------------------------------|
| 9        | 18226    | Timer, 60 Minute, 60 Hz            |
|          | 20084    | Timer, 60 Minute, 50 Hz            |
| 10       | 36755    | Thermal Switch                     |
| 11       | 36700    | Transformer, 120/240 to 24V        |
| 12       | 20350    | Buzzer, 240V                       |
| 13       | 56760    | Thermal Switch, Manual Reset       |
| 14       | 57562    | Probe, 1k OHM, RTD 3/16" Terminals |
| 15       | 57381    | Panel & Decal                      |

# SOLID STATE DIGITAL CONTROL

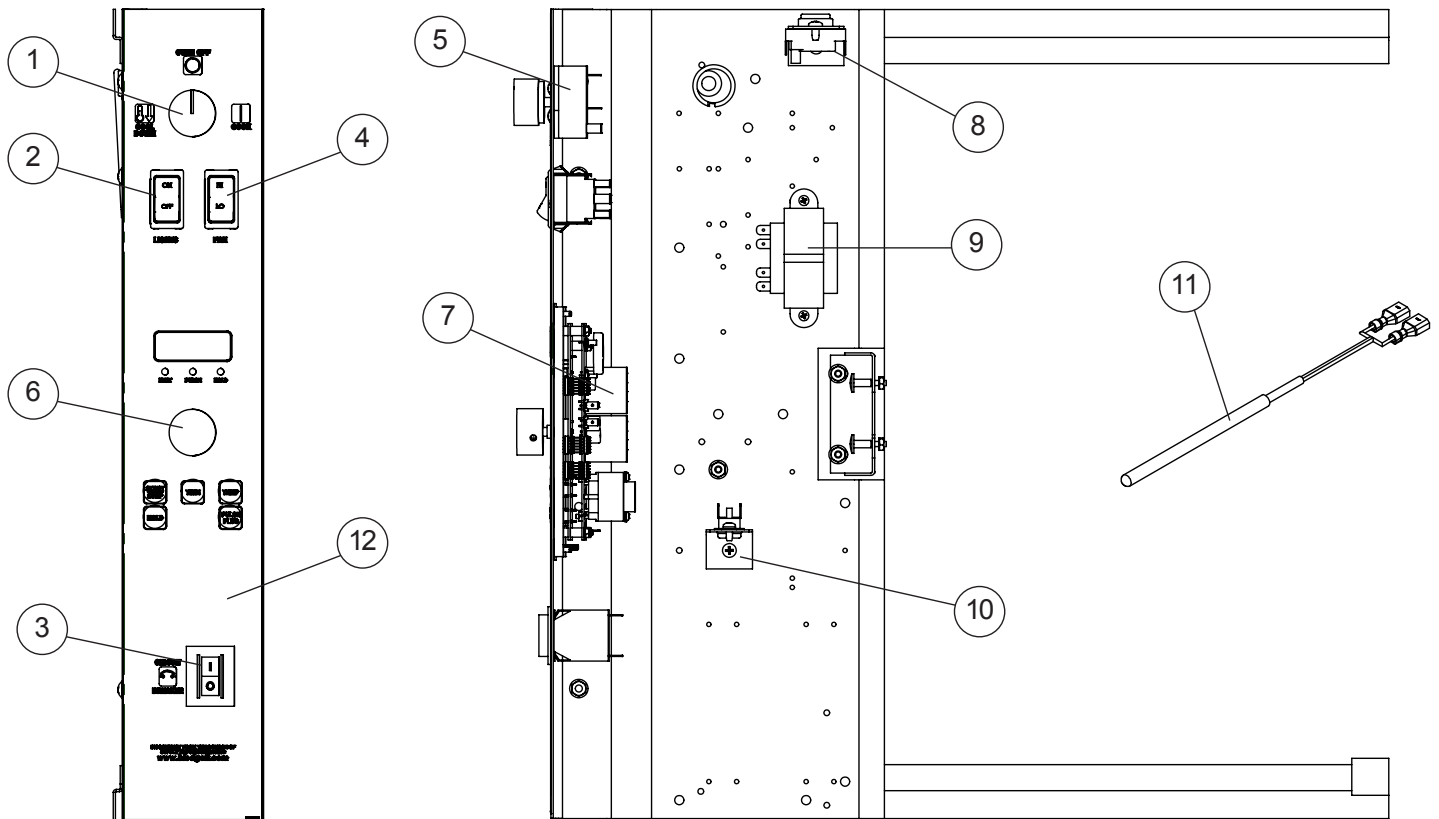

| Ref. No. | Part No. | Description                     |
|----------|----------|---------------------------------|
| 1        | 24684    | Knob Mode                       |
| 2        | 6497     | Light Switch, Rocker SPST White |
| 3        | 36429    | Circuit Breaker                 |
| 4        | 20530    | Blower Switch, Rocker 3PDT      |
| 5        | 18868    | Mode Switch                     |
| 6        | 24685    | Knob, Adjust                    |

| Ref. No. | Part No. | Description                        |
|----------|----------|------------------------------------|
| 7        | 58718    | SSD Time/Temp Control              |
| 8        | 36755    | Thermal Switch                     |
| 9        | 36700    | Transformer, 120/240 to 24V        |
| 10       | 56760    | Thermal Switch, Manual Reset       |
| 11       | 57562    | Probe, 1K OHM, RTD 3/16" Terminals |
| 12       | 58719    | Panel & Decal                      |

# SIMPLE TOUCH CONTROL

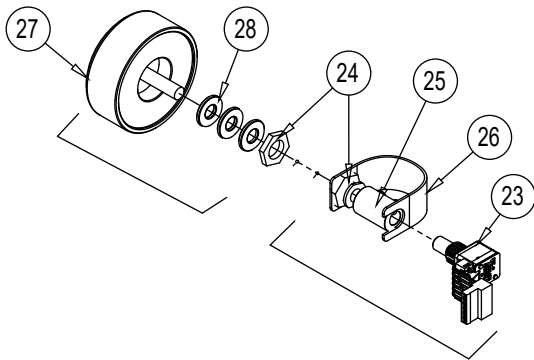
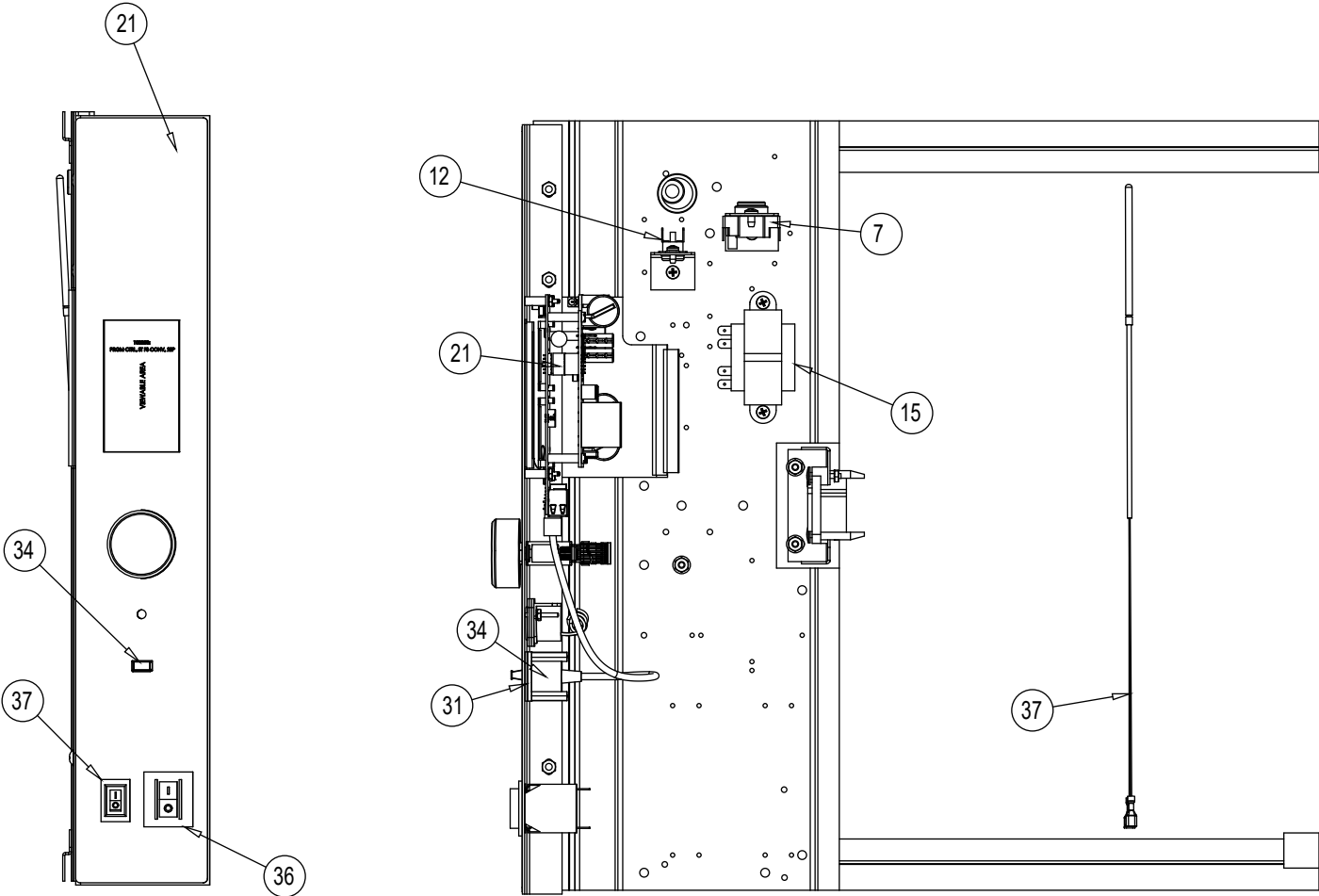



# SIMPLE TOUCH CONTROL

| <b>Ref. No.</b> | <b>Part No.</b> | <b>Description</b>                  | <b>Ref. No.</b> | <b>Part No.</b> | <b>Description</b>                      |
|-----------------|-----------------|-------------------------------------|-----------------|-----------------|---|
| 1               | 36483           | PANEL, CONTROL MOUNTING             | 21              | 100258          | PRGM CTRL, ST FS CONV, 2SP              |
| 2               | M3950           | #10-24 HEX FLANGED NUT              | 22              | R5481           | NUT, KEPS #4-40                         |
| 3               | 100599          | PANEL, CTRL MKV, ST                 | 23              | 59282           | ENCODER, MANUAL CONTROL                 |
| 4               | 16384           | 10-24 X .500 TRUSS HEAD MACH SCREW  | 24              | 60337           | SHAFT, LEAD IN                          |
| 5               | 37488           | BRACKET, THERMAL DISK               | 25              | 59439           | COUPLING, 1/4", SET SCREW.              |
| 6               | 15247           | SCREW, #10-16 X 5/8", SELF DRILLING | 26              | 60342           | PLASTIC BRACE                           |
| 7               | 36755           | SWITCH, THERMAL SPDT                | 27              | 60344           | KNOB, ENCODER                           |
| 8               | 4812            | SCREW, MACH, #10 x 3/8              | 28              | R0732           | WASHER, FLAT, #10                       |
| 9               | 56792           | BRACKET, THERMAL SWITCH             | 29              | 53921           | SPACER, REMOTE BUZZER                   |
| 10              | 20785           | SCREW, TAP, 8-32 x 3/8, PH PAN HEAD | 30              | 53759           | BUZZER, REMOTE                          |
| 11              | 1296            | WASHER, LOCK                        | 31              | 59280           | SPACER, FLUSH USB                       |
| 12              | 56760           | THERMAL SWITCH, MANUAL RESET        | 32              | 59434           | STANDOFF, #4-40X1"                      |
| 13              | 15847           | GROMMET, RUBBER 11/16               | 33              | 100330          | DUST COVER, USB                         |
| 14              | 19087           | GROMMET                             | 34              | 59565           | USB CABLE, STRAIGHT                     |
| 15              | 36700           | TRANSFORMER, 115/230V TO 24V 56VA   | 35              | 36429           | CIRCUIT BREAKER                         |
| 16              | 36655           | BRACKET, DRAWER CONNECTOR           | 36              | 36376           | SWITCH, GAS, ON/OFF                     |
| 17              | M9714           | SCREW, SHOULDER, AMP CONNECTOR      | 37              | 56873           | PROBE, 1K RTD 3/16 TERM                 |
| 18              | M3367           | NUT, 6-32 KEPS                      | 100613          |                 | HARNESS, MKV ST CTRL, RETRO (NOT SHOWN) |
| 19              | 59378           | EDGE PROTECTION                     |                 |                 |   |
| 20              | 100593          | DECAL, DFG-ES, ST                   |                 |                 |   |

# ELECTRICAL COMPONENTS

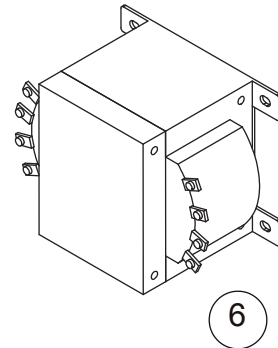
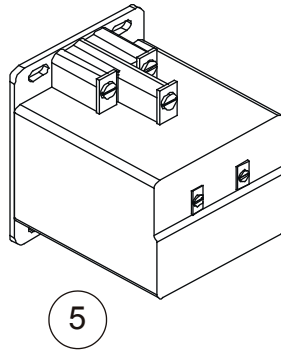
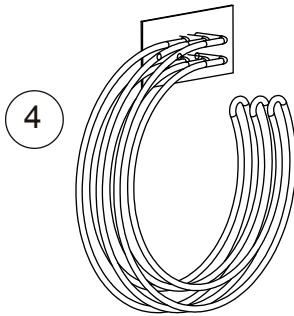
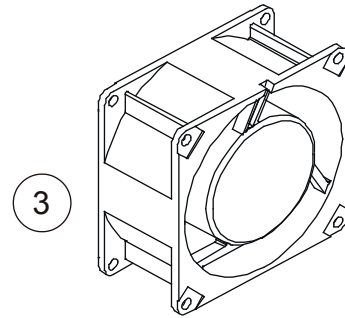
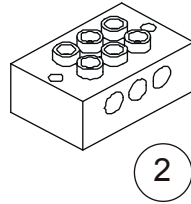
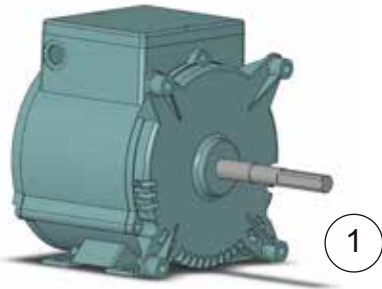

| <b>Ref. No.</b> | <b>Part No.</b> | <b>Description</b>             |
|-----------------|-----------------|--------------------------------|
| 1               | 32244           | Motor, 208/240V, 1 PH, 2 Speed |
| 2               | 17556           | Terminal Block, 3 Pole         |
|                 | 3574            | Terminal Block, 4 Pole         |
| 3               | 23034           | Axial Fan, 230V                |
|                 | M0571           | Fan Guard                      |
| 4               | 33245           | Element, 208V                  |

| <b>Ref. No.</b> | <b>Part No.</b> | <b>Description</b>        |
|-----------------|-----------------|---------------------------|
|                 | 33244           | Element, 240V             |
|                 | 20319           | Element, 480V             |
| 5               | 38559           | Contactator, 40 amp       |
|                 | 53235           | Contactator, 65 amp       |
| 6               | 17754           | Transformer, 480VAC, 1KVA |

## EXTERIOR COMPONENTS

| <u>Ref. No.</u> | <u>Part No.</u> | <u>Description</u>                            |
|-----------------|-----------------|---|
|                 | 37202           | Trim Assy., Bottom S/S (w/o security package) |
|                 | 21104           | Flue Box, Single Oven                         |
|                 | 21107           | Flue Assy., Stacking (3 Piece)                |
|                 | 36407           | Bodyside, RH S/S (11-21-05 and after)         |
|                 | 37205           | Bodyside, LH S/S (11-21-05 and after)         |
|                 | 38981*          | Bodytop S/S                                   |
|                 | 8600            | Legs, 6" w/ Bolts, S/S (Set of 4)             |
|                 | 33196           | Legs, 6" w/Bolts & Seismic Feet (Set of 4)    |
|                 | 8598            | Legs, 25" w/ Bolts, S/S (Set of 4)            |
|                 | 7847            | Leg Bolts (Set of 8)                          |
|                 | 92000           | Leg Studs (Set of 4)                          |
|                 | 21053           | Open Stand w/ Feet, S/S                       |
|                 | 20878           | Open Stand w/ Casters, S/S                    |
|                 | 16002           | Caster Kit, Sgl Oven (Set of 4)               |
|                 | 5779            | Caster Kit, Dbl Oven (Set of 4)               |
|                 | 19528           | Caster Kit, Low Profile (Set of 4))           |
|                 | 34565           | Brackets, Dbl Stacking (Set of 2)             |
|                 | 54422           | Side Heat Shield, Right or Left               |
|                 | 32874           | Element Terminal Box                          |

## ROLL-IN UNIT AND PARTS

| <u>Ref. No.</u> | <u>Part No.</u> | <u>Description</u>                      |
|-----------------|-----------------|---|
|                 | 20517           | Docking Plate Assy.                     |
|                 | 8355            | Docking Pins, Transport Cart (Set of 2) |
|                 | 8356            | 5" Casters, Transport Cart (Set of 4)   |
|                 | 9052            | Handle, Transport Cart (Sgl Oven)       |
|                 | 8359            | Catch Mechanism, Transport Cart         |
|                 | 8357            | Locking Bar, Transport Cart             |
|                 | 8358            | Tracks & Shelf Assy., Transport Cart    |
|                 | 9015            | Handle, Transport Cart (Dbl Oven)       |
|                 | 7931            | Vertical Posts (Each)                   |
|                 | 51659           | Track, LH                               |
|                 | 51660           | Track, RH                               |
|                 | 21089           | Rack Stop, S/S                          |
|                 | 7689            | Transport Cart, CTRG                    |
|                 | 8626            | Transport Cart, CTRG-2                  |
|                 | 24607           | Roll-In Basket Dolly, DBRI-L            |
|                 | 11206           | Roll-In Pan Rack, RPR-L9 (w/ 5 Racks)   |
|                 | 7590            | Racks for Pan Rack, L9 (26" x 26")      |
|                 | 59657*          | Front Trim Kit, Bodytop                 |

**NOTE\*** *For ovens pre-dating 03/10/2017 parts 38981 & 59657 must be purchased/replaced together*